

# Save time and make your spreads / pages look like eye candy

1

SELECT THE LAYER TO WHICH YOU WANT TO ATTACH THE IMAGE

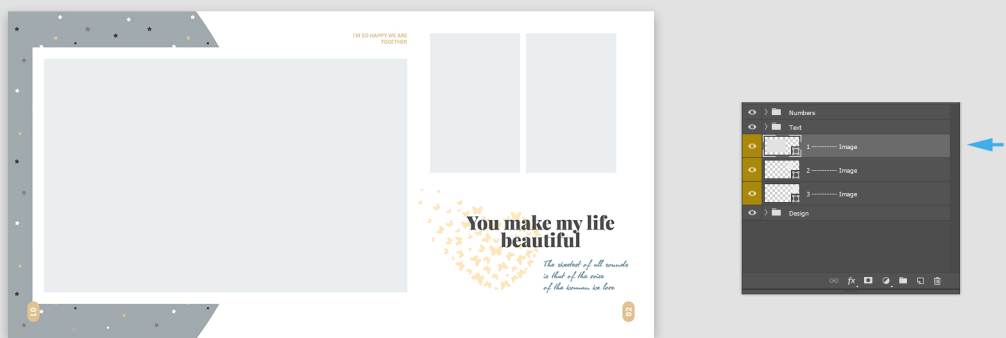

2

PLACE IMAGE

- 1

In the Actions palette  
Select the "Place image" operation  
And click on the triangle button  
"Play"
- 1
- 2

Select a photo  
in the window that opens

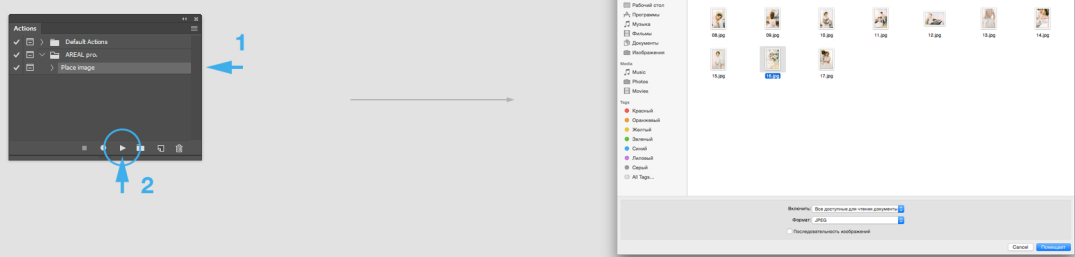

3

CHANGE THE SIZE

Hold down the Shift key to save the aspect ratio of the photo

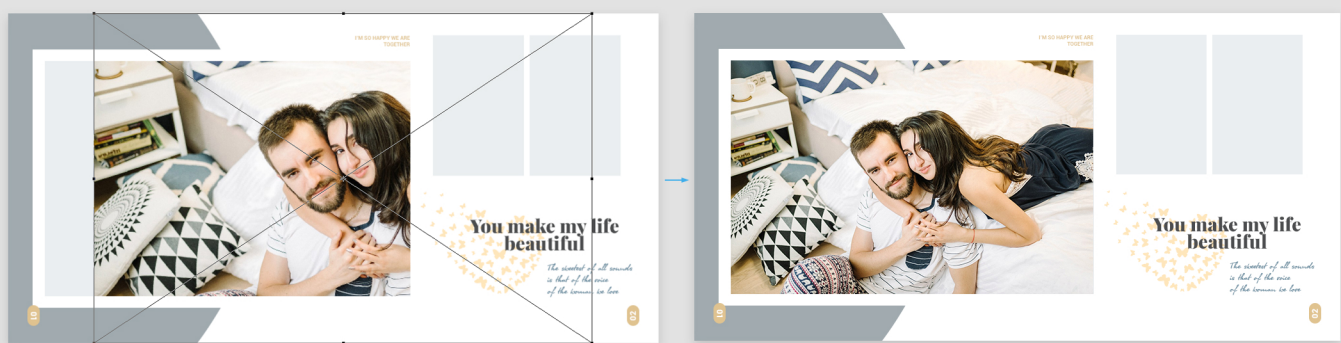

## IMPORTANT

For the correct operation of the Action, you must select only "Place photo"

